

STEELHEAD™ 300



AIR COOLED

HEAVY DUTY APPLICATIONS

ERGONOMIC HANDLE & TORCHNECK

PRODUCT DESIGNATION

Steelhead 300 10' (.045)Short Neck	TAS301045-1E (Euro)*
Steelhead 300 12' (.045)Short Neck	TAS301245-1E (Euro)*
Steelhead 300 15' (.045)Short Neck	TAS301545-1E (Euro)*
Steelhead 300 10' (.045)Long Neck	TAL301045-1E (Euro)*
Steelhead 300 12' (.045)Long Neck	TAL301245-1E (Euro)*
Steelhead 300 15' (.045)Long Neck	TAL301545-1E (Euro)*

* For other power pins, please designate with the following code: 1M(Miller), 1L (Lincoln), 2L(Lincoln 10).

TECHNICAL DATA

Steelhead 300		
300 AMPERES	100% Duty Cycle	w/CO2 Gas
200 AMPERES	100% Duty Cycle	w/ Mixed Gas

Wire Sizes: 0.030-0.062 inches (0.8-1.6mm)

Duty rating is based on a 10-minute cycle under NEMA arc welding section standard 11-6-1975

Complies with EN50078/IEC 60974-7

United States:
Nasarc Industries, Inc.
103 W. College Avenue, Suite 200
Appleton, Wisconsin 54911
Tel: (888) 844-0991 Fax: (920) 380-2399

Canada:
Nasarc Technologies, Inc.
695 McMurray Road, Unit 6
Waterloo, Ontario, Canada N2V2B7
Tel: (519) 747-0336 Fax: (519) 886-9022

Adapter Kits

Item #	Description	Part #
P1	Torch Power Pin-Euro(A)	TPP010001
P2	Torch Power Pin-Lincoln	TPP010002
P3	Torch Power Pin-Lincoln 10	TPP010003
P4	Torch Power Pin-Miller	TPP010004
P5	Torch Power Pin-Tweco	TPP010005

Consumables - Front End

Item #	Description	Part #
C8	Contact Tip C8 .030 (0.8mm)	TCC010830
C8	Contact Tip C8 .035 (0.9mm)	TCC010835
C8	Contact Tip C8 .045 (1.2mm)	TCC010845
C8	Contact Tip C8 .052 (1.4mm)	TCC010852
C8	Contact Tip C8 .062 (1.6mm)	TCC010862
T8	Tip Holder, 1" (25mm) C8	TCT010802
T8	Tip Holder, 1 1/8" (29mm) C8	TCT010803
D1	Diffusor, Brown	TCD010005
D1	Diffusor, White	TCD010006
D1	Diffusor, Ceramic 50	TCD010007
N1	Nozzle, Standard 5/8" (16mm)	TCN010007
N1	Nozzle, Heavy Duty 5/8" (16mm)	TCN010008
N2	Nozzle, Tapered 9/16" (14mm)	TCN010009
N3	Nozzle, Straight 3/4" (19mm)	TCN010010
N2	Nozzle, Tapered 1/2" (12mm)	TCN010012

Parts

Item #	Description	Part #
G1	Torch Neck, S300-Short	TPG011300
G2	Torch Neck, S300-Long	TPG011301
G3	Torch Body S2-S3	TPG010003
H1	Handle, Black S2-S5	TPH011025
H2	Trigger, Red, Std.	TPH010001
H3	Screw, Handle	TPH010002
A1	Nut, Hex M10X1	TPA010001
A2	Trigger Wire Lug, Female	TPA010002
A3	Trigger Wire Conn., Male	TPA010003
A4	Cable Assembly, 50QMM (10')	TPA015010
A4	Cable Assembly, 50QMM (12')	TPA015012
A4	Cable Assembly, 50QMM (15')	TPA015015
S1	Strain Relief, 16-50QMM	TPS011650
S2	Handle, Back-End	TPS010120
S3	Screw, M4X6	TPS010046
L1	Liner, .035-.045 (0.9-1.2mm) 10'	TPL010210
L1	Liner, .035-.045 (0.9-1.2mm) 12'	TPL010212
L1	Liner, .035-.045 (0.9-1.2mm) 15'	TPL010215
L1	Liner, .045-.062 (1.2-1.6mm) 10'	TPL010310
L1	Liner, .045-.062 (1.2-1.6mm) 12'	TPL010312
L1	Liner, .045-.062 (1.2-1.6mm) 15'	TPL010315
L2	Liner Collet .035-.045 (0.9-1.2mm)	TPL013545
L2	Liner Collet .045-.062 (1.2-1.6mm)	TPL014562

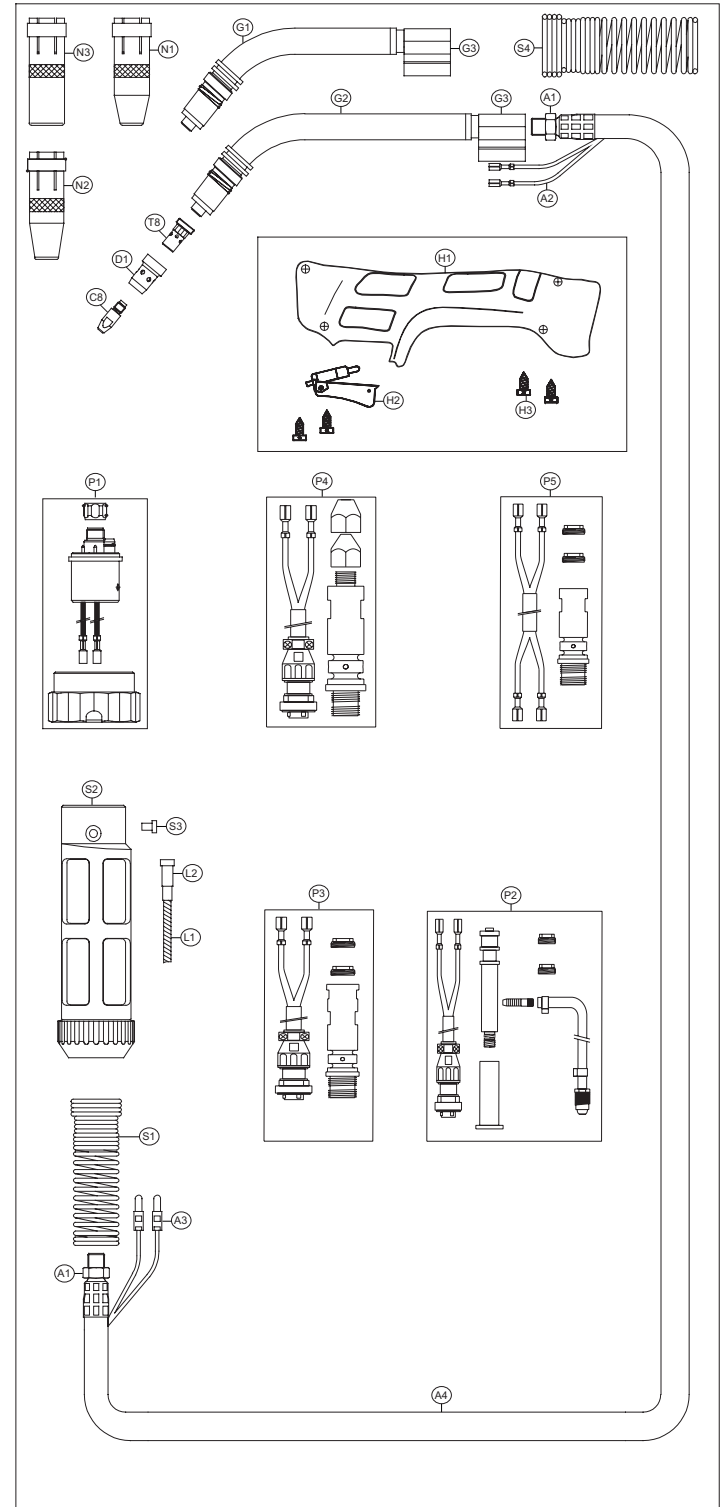

For more information, contact your local Nasarc distributor.