

**STEELHEAD™ 500W**



**WATER COOLED**

**ERGONOMIC SWIVEL HANDLE**

**ROBUST FRONT END SYSTEM**

**HEAVY DUTY APPLICATIONS**

**PRODUCT DESIGNATION**

Steelhead 500W 10' (.045)Short Neck	TAS501045-1E (Euro)*
Steelhead 500W 12' (.045)Short Neck	TAS501245-1E (Euro)*
Steelhead 500W 15' (.045)Short Neck	TAS501545-1E (Euro)*
Steelhead 500W 10' (.045)Long Neck	TAL501045-1E (Euro)*
Steelhead 500W 12' (.045)Long Neck	TAL501245-1E (Euro)*
Steelhead 500W 15' (.045)Long Neck	TAL501545-1E (Euro)*

\* For other power pins, please designate with the following code: 1M(Miller), 1L (Lincoln), 2L(Lincoln 10).

**TECHNICAL DATA**

Steelhead 500W		
500 AMPERES	100% Duty Cycle	w/CO2 Gas
450 AMPERES	100% Duty Cycle	w/ Mixed Gas
Wire Sizes: 0.035-0.098 inches (0.9-2.4mm)		

Duty rating is based on a 10-minute cycle under NEMA arc welding section standard 11-6-1975

Complies with EN50078/IEC 60974-7

United States:  
Nasarc Industries, Inc.  
103 W. College Avenue, Suite 200  
Appleton, Wisconsin 54911  
Tel: (888) 844-0991 Fax: (920) 380-2399

Canada:  
Nasarc Technologies, Inc.  
695 McMurray Road, Unit 6  
Waterloo, Ontario, Canada N2V2B7  
Tel: (519) 747-0336 Fax: (519) 886-9022

**Adapter Kits**

Item #	Description	Part #
P1	Torch Power Pin-Euro(W)	TPP010007
P2	Torch Power Pin-Lincoln	TPP010002
P3	Torch Power Pin-Lincoln 10	TPP010003
P4	Torch Power Pin-Miller	TPP010004
P5	Torch Power Pin-Tweco	TPP010005

**Consumables - Front End**

Item #	Description	Part #
C8	Contact Tip C8 .030 (0.8mm)	TCC010830
C8	Contact Tip C8 .035 (0.9mm)	TCC010835
C8	Contact Tip C8 .045 (1.2mm)	TCC010845
C8	Contact Tip C8 .052 (1.4mm)	TCC010852
C8	Contact Tip C8 .062 (1.6mm)	TCC010862
T8	Tip Holder, 1" (25mm) C8	TCT010802
T8	Tip Holder, 1 1/8" (29mm) C8	TCT010803
D1	Diffusor, Brown	TCD010005
D1	Diffusor, White	TCD010006
D1	Diffusor, Ceramic 50	TCD010007
D1	Diffusor, Black	TCD010008
N1	Nozzle, Standard 5/8" (16mm)	TCN010007
N1	Nozzle, Heavy Duty 5/8" (16mm)	TCN010008
N2	Nozzle, Tapered 9/16" (14mm)	TCN010009
N3	Nozzle, Straight 3/4" (19mm)	TCN010010
N5	Nozzle, Tapered 1/2" (12mm)	TCN010012

**Parts**

Item #	Description	Part #
G1	Torch Neck, Short S500W	TPG011501
G2	Torch Neck, Long S500W	TPG011502
G3	Insulating Washer S56	TPG010005
H1	Handle, Black S3-5W	TPH011035
H2	Trigger, Red, Std.	TPH010001
H3	Screw, Handle	TPH010002
A2	Trigger Wire Lug, Female	TPA010002
A3	Trigger Wire Conn, Male	TPA010003
A4	Cable Assembly, W (10')	TPA010005
A4	Cable Assembly, W (12')	TPA010006
A4	Cable Assembly, W (15')	TPA010007
A5	Fitting, Cable	TPA010008
A6	Support, Spring	TPA010009
A7	Spring	TPA010010
A8	Cable Support	TPA010011
A9	Strain Relief Assembly	TPA010012
B1	Cable Support Handle	TPA010013
S3	Screw, M4X6	TPS010046
L1	Liner, N/I .030-.035(0.8-0.9mm) 10'	TPL010410
L1	Liner, N/I .030-.035(0.8-0.9mm) 12'	TPL010412
L1	Liner, N/I .030-.035(0.8-0.9mm) 15'	TPL010415
L1	Liner, N/I .035-.045(0.9-1.2mm) 10'	TPL010510
L1	Liner, N/I .035-.045(0.9-1.2mm) 12'	TPL010512
L1	Liner, N/I .035-.045(0.9-1.2mm) 15'	TPL010515
L1	Liner, N/I .045-.062(1.2-1.6mm) 10'	TPL010610
L1	Liner, N/I .045-.062(1.2-1.6mm) 12'	TPL010612
L1	Liner, N/I .045-.062(1.2-1.6mm) 15'	TPL010615
L2	Liner Collet .030-.035 (0.8-0.9mm)	TPL013035
L2	Liner Collet .035-.045 (0.9-1.2mm)	TPL013545
L2	Liner Collet .045-.062 (1.2-1.6mm)	TPL014562

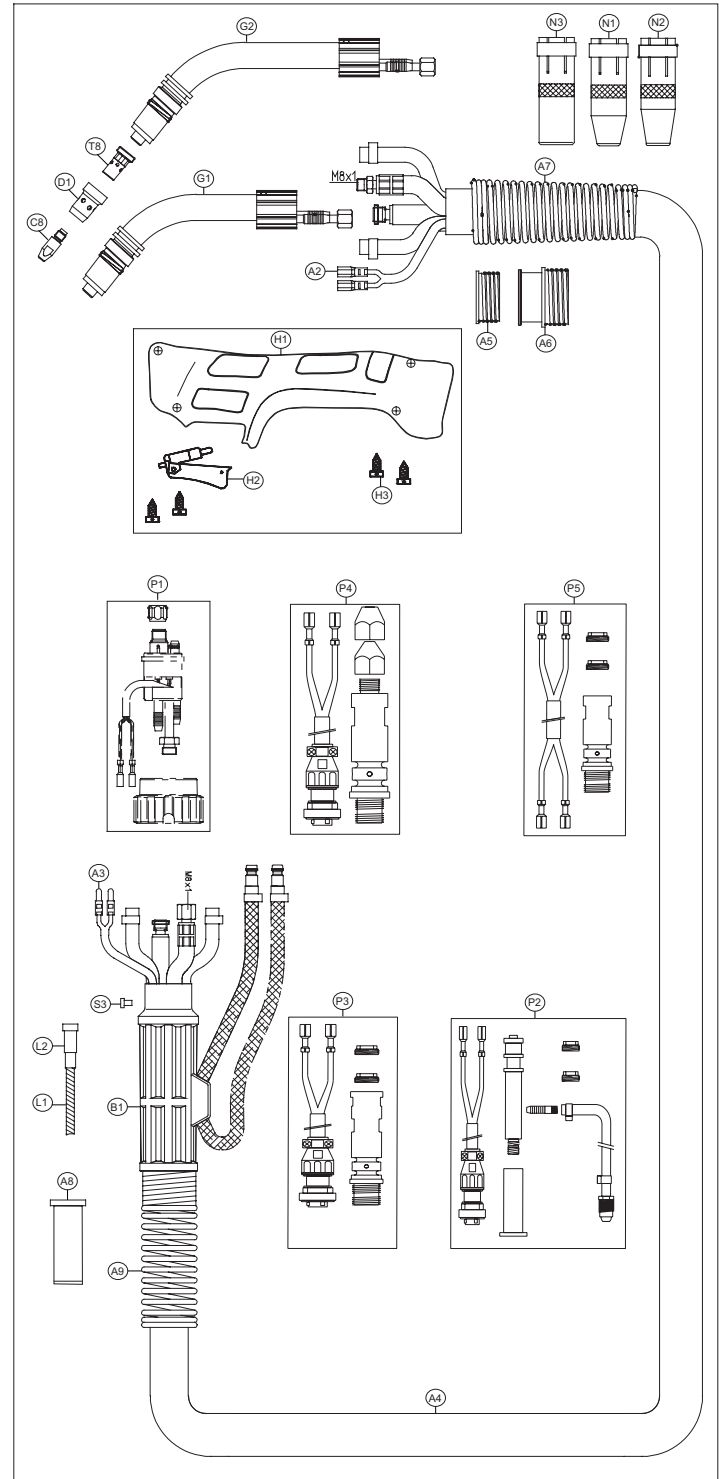

For more information, contact your local Nasarc distributor.